

Elevate your Foodservice Spaces with Award-Winning, Customized Design

Creating exceptional foodservice spaces in Senior Living requires a balance of functionality, technology, and aesthetics. By designing resident-centered environments, we help optimize your workflow while enhancing the dining experience for residents. From production kitchens to serving areas like cafés, bistros, and bars, every aspect of your project benefits from tailored technical expertise.

Working collaboratively with your interior design and operations teams, we focus on understanding your project goals, space limitations, and resident needs. This partnership ensures the latest design innovations and technologies are applied for optimal solutions, maximizing efficiency for both front and back of house.

Early collaboration is key to success, allowing for proactive planning and seamless integration of design elements. Our cloud-based tools support efficient project management, while ongoing, transparent communication keeps your project aligned with your vision from start to finish.



1-844-4APTURA Aptura.net

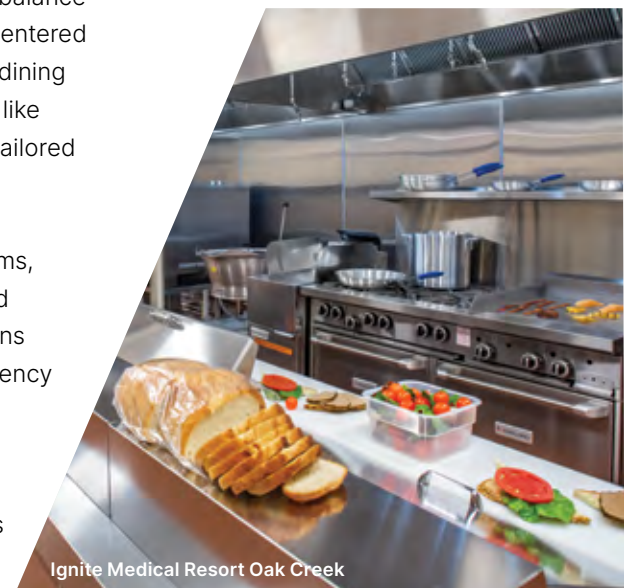
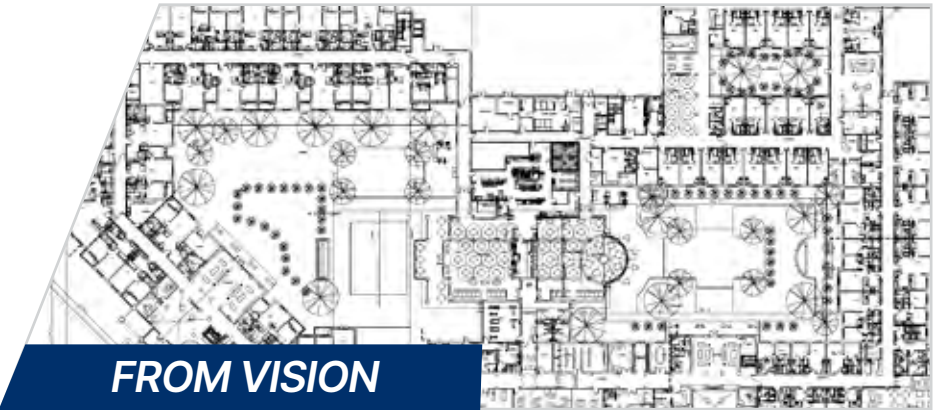

Optimize Your Dining Services with Servi Plus

In today's challenging staffing environment, Servi Plus offers a smart solution to keep your dining operations efficient and engaging. By integrating Servi technology, you can fill staffing gaps to save an estimated \$40,000 annually in labor costs.*

Position Your Community as a Leader in Modern Dining

- Consistent service with no sick days or no-shows
- Reduces burnout and supports staff retention
- Expedites food delivery, improving overall dining experience



Let's bring your
foodservice vision to life.

1-844-4APTURA
Aptura.net

*Labor cost savings vary depending on your staffing needs, labor rates, and length of lease. Assumes existing wi-fi connection. Shipping and deployment costs not included in calculation. Contact us to calculate savings for your unique community.

©2024 Direct Supply, Inc. All rights reserved. 19248 9/24